

TRIG-STAR PROBLEM LOCAL CONTEST

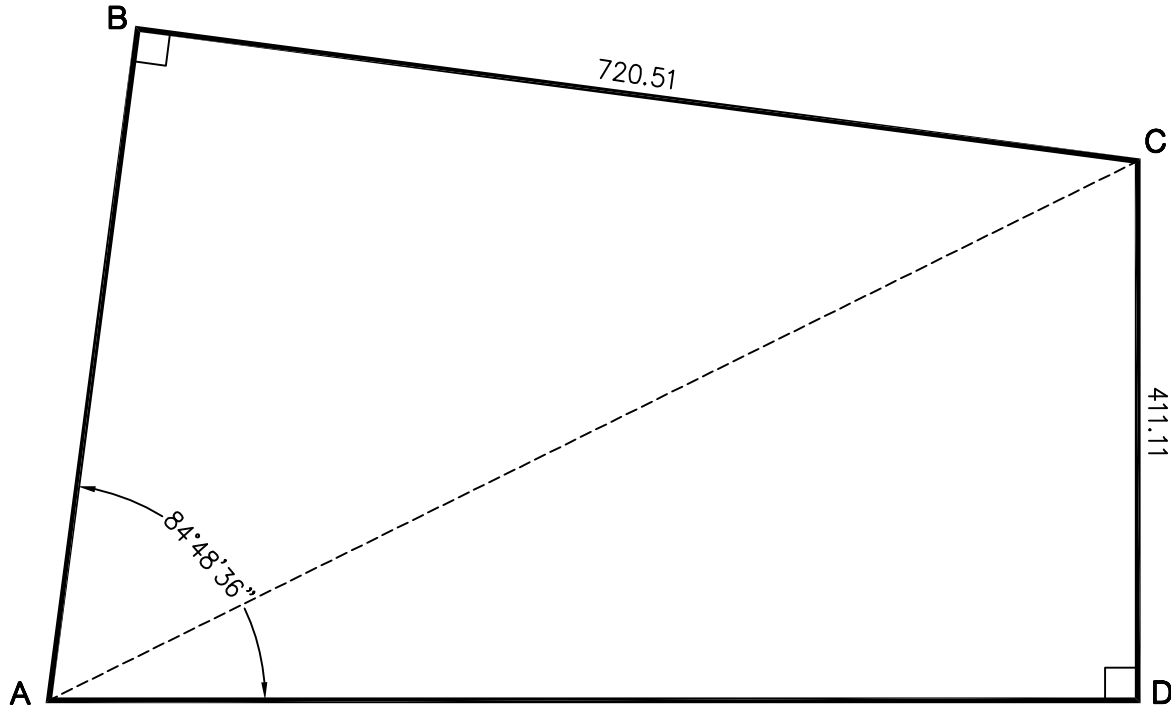

KNOWN: DISTANCE BC = 720.51 DISTANCE CD = 411.11
 \angle BAD = 84°48'36"

FIND: DISTANCE AB = _____ (10 POINTS)
DISTANCE AD = _____ (10 POINTS)
DISTANCE AC = _____ (10 POINTS)

REQUIRED ANSWER FORMAT
DISTANCES: NEAREST HUNDREDTH

PAGE TOTAL: _____ POINTS